

House District(s) _____

Senate District(s) _____

**THE TWENTY-NINTH LEGISLATURE
APPLICATION FOR GRANTS
CHAPTER 42F, HAWAII REVISED STATUTES**

Log No: _____

For Legislature's Use Only

Type of Grant Request:

GRANT REQUEST – OPERATING

GRANT REQUEST – CAPITAL

"Grant" means an award of state funds by the legislature, by an appropriation to a specified recipient, to support the activities of the recipient and permit the community to benefit from those activities.

"Recipient" means any organization or person receiving a grant.

STATE DEPARTMENT OR AGENCY RELATED TO THIS REQUEST (LEAVE BLANK IF UNKNOWN): _____

STATE PROGRAM I.D. NO. (LEAVE BLANK IF UNKNOWN): _____

1. APPLICANT INFORMATION:

Legal Name of Requesting Organization or Individual:

Db: Maui Arts & Cultural Center

Street Address: One Cameron Way, Kahului, Hawaii
96732

Mailing Address: One Cameron Way, Kahului, Hawaii
96732

2. CONTACT PERSON FOR MATTERS INVOLVING THIS APPLICATION:

Name ARTHUR J. VENTO

Title President and CEO

Phone # 808.243.4264

Fax # 808.242.4665

E-mail art@mauiarts.org

3. TYPE OF BUSINESS ENTITY:

- NON PROFIT CORPORATION INCORPORATED IN HAWAII
- FOR PROFIT CORPORATION INCORPORATED IN HAWAII
- LIMITED LIABILITY COMPANY
- SOLE PROPRIETORSHIP/INDIVIDUAL
- OTHER

6. DESCRIPTIVE TITLE OF APPLICANT'S REQUEST:

COMPLETION OF NEXT STEPS OF THE MAUI ARTS & CULTURAL CENTER'S MASTER PLAN INCLUDING THE DESIGN AND CREATION OF ADDITIONAL DANCE STUDIOS /CLASSROOMS AND ARCADE AND COMPLETION OF THE COMMUNITY STAGE AND EVENTS LAWN INCLUDING STAGE COVER, INFRASTRUCTURE, SUPPORT SPACES AND OUTFITTING.

4. FEDERAL TAX ID #: [REDACTED]

5. STATE TAX ID #: [REDACTED]

7. AMOUNT OF STATE FUNDS REQUESTED:

FISCAL YEAR 2019: \$4,500,000

8. STATUS OF SERVICE DESCRIBED IN THIS REQUEST:

- NEW SERVICE (PRESENTLY DOES NOT EXIST)
- EXISTING SERVICE (PRESENTLY IN OPERATION)

SPECIFY THE AMOUNT BY SOURCES OF FUNDS AVAILABLE AT THE TIME OF THIS REQUEST:

STATE \$1,000,000

FEDERAL \$0

COUNTY \$870,000

PRIVATE/OTHER \$350,000

ARTHUR J. VENTO PRESIDENT & CEO
NAME & TITLE

1/13/18
DATE SIGNED

JAN 19 2018
12569

Application for Grants

If any item is not applicable to the request, the applicant should enter "not applicable".

I. Background and Summary

This section shall clearly and concisely summarize and highlight the contents of the request in such a way as to provide the State Legislature with a broad understanding of the request. Please include the following:

1. A brief description of the applicant's background;

Described by The Maui News as the “educational and artistic heart of an entire community,” The Maui Arts & Cultural Center (MACC) is Hawai‘i’s only comprehensive, multi-disciplinary non-profit arts facility. In May 2014, The MACC celebrated its 20th year. In 2010, The Center’s Board and principal staff members rearticulated its mission, which is *to inspire people through personal and shared experiences of the arts achieved through learning, access & exposure, performances & exhibits.*

Since opening its doors, the MACC has served more than 4.8 million people, averaging 250,000 people through more than 1,700 activities annually. Over 66% of MACC’s events are community-based, serving children to seniors. The MACC is an economic engine for Maui and the State of Hawaii. The MACC, with an annual operating budget of over \$8M, of which the majority is spent on Maui and in Hawaii, is a significant source of direct and indirect economic activity in the State of Hawaii. **In addition, over \$4.5 million in ancillary income is generated annually** in revenue to community businesses through performers, corporate groups, and audiences residing on or coming to Maui to participate in Maui Arts & Cultural Center activities. Furthermore, these activities create jobs. Economic studies show that for every \$100,000 the MACC spends, up to 1.98 jobs are created on Maui. When the direct spending and ancillary income are combined, the MACC, in payroll, direct and indirect spending **generates over 200 jobs in Hawaii.**

2. The goals and objectives related to the request;

Capital Campaign support in 2008, primarily from private contributions, helped to complete the construction of the Yokouchi Family Pavilion/Courtyard in January 2011. As a result, the MACC achieved one of its objectives in building an outdoor venue sophisticated enough to consistently attract world class entertainers as well as showcase the best talent of Hawaii.

Priority 3: Completion of the Community Events Lawn Support Infrastructure

- Build the Community Stage & Event Lawn to allow for flexibility in scheduling outdoor event. Should an event need to be outside on a very particular date, while a Castle Theater event is already booked, the event can proceed in the community venue and not compromise with the traffic flow in and out of the Castle Theater.

Completion of the support infrastructure is to include but not limited to: installation of power distribution, area lighting, restrooms and landscaping.

Creation of entrances for the restrooms from both the Events Lawn direction and the Amphitheater side will allow for maximum accessibility and use, depending upon which areas are in use at any given time.

The addition of built-in bathrooms would eliminate the rental expense for portable toilets and create a sense of permanence and comfort for the public using the spaces.

Installation of a gated pedestrian entrance to the Community Stage & Events Lawn from the A&B Amphitheater via a small plaza controls transitions from one venue to the other venue as needed.

Priority 4: Completion of the Community Stage Support Spaces and Outfitting

- The building of support spaces and outfitting of the Community Stage & Events Lawn creates additional opportunities in the future, beyond the community access to host nationally touring festivals that require multiple stages to be set up for staggered use throughout the day. Other festival concepts made possible by completion of the Events Lawn include food or beverage themed events that require the support areas for food, be separate from the reserved seating area for the musical portion of the event.

The landscape area are to be consistent with the existing parking lots and hillside. Convenient access to parking to be provided.

Complete dressing rooms, support spaces and arcades for the community stage and events lawn

The FY 2018-2019 funding priorities listed will enable us to adapt our business model for growing audiences and changing demographics on Maui as we continue to build on the extraordinary public and private investments that have established and sustained the MACC over the past twenty-three years.

The MACC consistently seeks multiple sources of funding for capital improvements. In keeping with this model in addition to state GIA FY2018-2019 requested, MACC has secured 2.2 million in funding from public, private and foundation sources. Last year's awarded FY2017-2018 GIA grant funded the maintenance and event storage building, an

3. The public purpose and need to be served;

Inspiration from Learning

MACC has the mission of inspiring learning through experiences with the arts. By increasing our capacity to serve more diverse and concurrent performances and festivals, MACC increases its service to the growing population of Maui, adds scheduling flexibility which in turn can improve our operating bottom line. In so doing, MACC enhances its ability to preserve and share Hawaiian culture, build community and influence the creativity and innovative capacity of children attending schools on Maui, Lana'i and Moloka'i.

Inspiration from Performances & Exhibits

In addition to high standards of excellence, MACC performances and exhibits are selected to create experiences that are "unique, memorable, and life-affirming." *MACC Presents*, our annual performing and visual arts season, connects Maui's three-island community to the world through programs that attract nearly 80,000 island residents and visitors. These performances include MACC's free visual arts exhibits and innovative events (Maui 'Ukulele Festival, Starry Night Cinemas, Art=Mixx and the Kī Hō'alu Festival) that engage a broad cross-section of people through carefully tailored programming. Even with all these various presentations and activities, there are opportunities to add events in the new Community Stage and Events Lawn.

4. Describe the target population to be served; and

The 158,226ⁱ residents of Maui's tri-island county comprise the MACC's two most important target audience groups, each with very distinct personas whose arts and cultural traditions shape our distinctive culture. They are the: 144,444 residents of Maui island's diverse communities (29% Asian, 10% native Hawaiian & Pacific Islander, 12% Hispanic or Latino, 23% two or more races), and the 13,782 county residents in geographically remote areas that do not receive access to arts activities on a regular basis: the isolated town of Hāna, Maui (29% Hawaiian & Pacific Asian Islander), the islands of Lāna'i (55% Asian), and Moloka'i (26% Hawaiian).ⁱⁱ

5. Describe the geographic coverage.

The MACC serves all of Maui County including, outreach education programs that travel to Hana, as well as the islands of Lana'i and Moloka'i. The MACC brings the arts to areas of Maui County that are unable to travel to the MACC.

In addition the MACC regularly features artists from around the globe and welcomes visitors from across the U.S. and internationally.

II. Service Summary and Outcomes

- Assemble project team of architects, engineers and construction management consultants.
- Review project with County of Maui building Department to identify any potential obstacles.

January – March 2019

- Complete design development documents and begin construction documents for project components.

March – June 2019

- Complete construction documents and issue construction documents for bid to contractors.
- Select contractor and negotiate contract.

July 2019 – June 2020

- Contract complete and executed
- Notice to proceed given to contractor.
- Work proceeds with a 12 month construction schedule.

3. Describe its quality assurance and evaluation plans for the request. Specify how the applicant plans to monitor, evaluate, and improve their results; and

The MACC will establish the timeline with construction deliverables in close consultation with its Board Facilities Committee, whose members have extensive experience in construction. All plans and construction will be held to the high standard already in evidence in every facet of the MACC's existing design and construction. At critical junctures, evaluation of plans will be conducted both internally and by hired professional consultants to ensure that all plans meet the high standards of construction that are the hallmark of the MACC. The same MACC staff is in place for this project that has successfully overseen completion of over 50 million in capital improvements at the MACC in the past 24 years.

4. List the measure(s) of effectiveness that will be reported to the State agency through which grant funds are appropriated (the expending agency). The measure(s) will provide a standard and objective way for the State to assess the program's achievement or accomplishment. Please note that if the level of appropriation differs from the amount included in this application that the measure(s) of effectiveness will need to be updated and transmitted to the expending agency.

If all or a portion of funding from the State is not received the MACC will re-define the scope and timeline of the project to complete portions of the project that are funded.

Measures of Effectiveness

- William & Margery Zellerback Foundation, programs, seeking \$5,000
4. **The applicant shall provide a listing of all state and federal tax credits it has been granted within the prior three years. Additionally, the applicant shall provide a listing of all state and federal tax credits they have applied for or anticipate applying for pertaining to any capital project, if applicable.**

The Maui Arts & Cultural Center is a tax exempt 501 c 3 Organization

5. **The applicant shall provide a listing of all federal, state, and county government contracts, grants, and grants in aid it has been granted within the prior three years and will be receiving for fiscal year 2019 for program funding.**

Please see attachment listing Government Contracts, grants and grants in aid for the past three years for program funding.

6. **The applicant shall provide the balance of its unrestricted current assets as of December 31, 2017.**

\$25,085,769

IV. Experience and Capability

1. Necessary Skills and Experience

The applicant shall demonstrate that it has the necessary skills, abilities, knowledge of, and experience relating to the request. State your experience and appropriateness for providing the service proposed in this application. The applicant shall also provide a listing of verifiable experience of related projects or contracts for the most recent three years that are pertinent to the request.

The MACC successfully completed the *Generations to Come* campaign in December of 2005. This capital improvement plan was a great achievement as we **successfully reached and exceeded a \$15.9 million** goal to add educational and institutional capacity and prepare for our next steps in infrastructure. These included: building a permanent pavilion over the Yokouchi Founders' Court and the Alexander & Baldwin Amphitheater stage; an additional hospitality and event space overlooking the Kahului harbor and Founders' Court; and an upgraded food and beverage service area with a prep kitchen. The 23 month construction project was completed in 2011 on time and on budget.

These recent projects were aimed at increasing capacity and **the largest percentage was funded through privately raised monies.** Our Community

Art Vento – *President & CEO*

Art Vento’s tenure at the Maui Arts & Cultural Center originally began as the Project Manager for the Center’s construction in 1992. He has been involved with the MACC from the ground up. Upon opening the facility in 1994, he became the Director of Operations, later named General Manager, Executive Vice President and eventually named President & CEO in October of 2010. Vento is an architect by training, who graduated with honors from the University of Notre Dame and also holds a secondary degree in art history. In Fort Lauderdale, Florida he managed the construction of the \$60 million Broward Center for the Performing Arts, where he was a key member of the design team. Vento brings a unique combination of skills to the Maui Arts & Cultural Center as the organization moves forward into the next twenty years. Vento’s background provides the skills required for this proposed project, bringing a combination of design and construction experience with the intimate knowledge of the MACC’s operations over the past 24 years, a seasoned grasp of the MACC business model and audiences in Maui and Hawaii, and vision of how this project will move the MACC forward.

Mike Foley, Facilities Engineer

Mike Foley has been with the MACC since 2003 and has over 30 years of engineering and facility management experience for hospitals and hotels around the world. He is responsible for the long-term and daily maintenance of the MACC’s facilities and grounds as well as overseeing the facilities budget. Prior to the MACC, Foley was the Chief Engineer at Four Seasons Hotels

Inger Tully – Development Director

Inger Tully has over 15 years of experience managing departments and projects for arts organizations throughout the State of Hawaii. She has been involved with grant writing and project management for Hui No’eau Visual Arts Center, The Contemporary Museum, Honolulu, Honolulu Museum of Art and Hawaii Community Foundation. She has served as a grant reviewer for the Hawaii State Foundation on Culture and the Arts and has served on the boards of Western Museum Association, Hawaii Museum Association and Hui No’eau Visual Arts Center. Tully holds a MFA with distinction in Museum Studies from the University of the Arts.

2. Organization Chart

The applicant shall illustrate the position of each staff and line of responsibility/supervision. If the request is part of a large, multi-purpose organization, include an organization chart that illustrates the placement of this request.

Received by the applicant for fiscal year 2018-19, but

The funds requested for 2018-2019 are to complete masterplan projects planned and started with a variety of funding sources. Additional funding will fund the next stage of the MACC's Master Plan, only as funds allow.

Not received by the applicant thereafter.

Initiation and planned construction will be deferred, if necessary, until funding can be secured. Anticipated revenue and expense budgets based on increased utilization of proposed facilities will be deferred in turn until the projects are funded and completed

- 5. Certificate of Good Standing (If the Applicant is an Organization)**
If the applicant is an organization, the applicant shall submit one (1) copy of a certificate of good standing from the Director of Commerce and Consumer Affairs that is dated no earlier than December 1, 2017.

Certificate is enclosed

- 6. Declaration Statement:**
The applicant shall submit a declaration statement affirming its compliance with Section 42F-103, Hawaii Revised Statutes

The Maui Arts & Cultural Center affirms compliance to Section 42F-103.

- 7. Public Purpose**
The applicant shall specify whether the grant will be used for a public purpose pursuant to Section 42F-102, Hawaii Revised Statutes.

The grant received by the Maui Arts & Cultural Center will be used for the public purpose as documented in this grant.

ⁱ 2012 Census, ⁱⁱ 2012 Maui County Data Book, ⁱⁱⁱ As of June 30, 2013, ^{iv} FY 2012-13 Artist in the Community and Performances for Students

5. Listing of all federal, state and county government contracts, grants and grants in aid it has been granted in the prior three years and will be receiving for fiscal year 2019 for program funding

Applicant: Maui Arts & Cultural Center

Contracts Total: \$ 803,264

	CONTRACT DESCRIPTION	EFFECTIVE DATES	AGENCY	GOVERNMENT ENTITY (U.S. / State / Haw / Hon / Kau / Mau)	CONTRACT VALUE
	Product Enrichment	01/2016 - 12/2016	HTA/CPEP	State	\$ 44,000
	Biennium Season Grant	07/2015 - 06/2016	HSFCA	State	\$ 18,628
	Artworks - presenting	07/2015 - 06/2016	NEA	U.S.	\$ 35,000
	Operating	07/2015 - 06/2016	OED -	Maui	\$ 318,270
	Programming	07/2015 - 06/2016	Dept. Housing & Human Services	Maui	\$ 425,360
	Celebrate Hawaii	01/2016 - 12/2016	HTA kukuolu Ola	State	\$ 26,000
	Operations	07/2016 - 06/2017	OED	Maui	\$ 318,270
	Programming	07/2016 - 06/2017	OED	Maui	\$ 424,360
	Product Enrichment	01/2016 - 12/2016	HTA/CPEP	State	\$ 15,000
	Product Enrichment	01/2016 - 12/2016	HTA/CPEP	State	\$ 14,000
	Product Enrichment	01/2016 - 12/2016	HTA/CPEP	State	\$ 15,000
	Biennium Season Grant	07/2016 - 06/2017	HSFCA	State	\$ 8,482
	Biennium Education Grant	07/2016 - 06/2017	HSFCA	State	\$ 10,000
	Artworks presenting	07/2016 - 06/2017	NEA	U.S.	\$ 10,000
	Operation	07/2017 - 06/2018	OED	Maui	\$ 318,000
	Programs	07/2017 - 06/2018	OED	Maui	\$ 424,360
	Community Enrichment	01/2017 - 12/2018	HTA	State	\$ 25,000
	Product Enrichment	01/2017 - 12/2018	HTA	State	\$ 13,000
	Biennium Season Grant	07/2017 - 06/2018	HSFCA	State	\$ 12,904
	Biennium Education Grant	07/2017 - 06/2018	HSFCA	State	\$ 10,000

BUDGET REQUEST BY SOURCE OF FUNDS

Period: July 1, 2018 to June 30, 2019

Applicant: Maui Arts & Cultural Center

BUDGET CATEGORIES	Total State Funds Requested (a)	Total Federal Funds Requested (b)	Total County Funds Requested (c)	Total Private/Other Funds Requested (d)
A. PERSONNEL COST				
1. Salaries	76,200			
2. Payroll Taxes & Assessments				
3. Fringe Benefits				
TOTAL PERSONNEL COST	76,200			
B. OTHER CURRENT EXPENSES				
1. Airfare, Inter-Island				
2. Insurance				
3. Lease/Rental of Equipment				
4. Lease/Rental of Space				
5. Staff Training				
6. Supplies				
7. Telecommunication				
8. Utilities				
9 Professional fees / consultants	806,400			
10				
11				
12				
13				
14				
15				
16				
17				
18				
19				
20				
TOTAL OTHER CURRENT EXPENSES	806,400			
C. EQUIPMENT PURCHASES				
D. MOTOR VEHICLE PURCHASES				
E. CAPITAL	4,617,400		870,000	350,000
TOTAL (A+B+C+D+E)	5,500,000			
SOURCES OF FUNDING		Budget Prepared By:		
(a) Total State Funds Requested*	5,500,000	Arthur J. Vento	808.243.4264	Phone
(b) Total Federal Funds Requested		[REDACTED]		Date
(c) Total County Funds Requested	870,000		1/19/18	
(d) Total Private/Other Funds Requested	350,000	Signature of Authorized Official		
TOTAL BUDGET	6,720,000	Arthur J. Vento, President & CEO		
		Name and Title (Please type or print)		

*\$1,000,000 of \$5,500,000 GIA approved from FY2017-18. FY2018-19 request is for remaining \$4,500,00

BUDGET JUSTIFICATION - PERSONNEL SALARIES AND WAGES

Period: July 1, 2018 to June 30, 2019

Applicant: Maui Arts & Cultural Center

POSITION TITLE	FULL TIME EQUIVALENT	ANNUAL SALARY A	% OF TIME ALLOCATED TO GRANT REQUEST B	TOTAL STATE FUNDS REQUESTED (A x B)
July 2018 - June 2020 (2 year project duration)				\$ -
Arthur J. Vento President & CEO		\$135,000.00	30.00%	\$ 40,500.00
Michael Foley, Facility Engineer		\$79,000.00	30.00%	\$ 23,700.00
Inger Tully, Development Director		\$75,000.00	16.00%	\$ 12,000.00
				\$ -
				\$ -
				\$ -
				\$ -
				\$ -
				\$ -
				\$ -
				\$ -
				\$ -
				\$ -
				\$ -
				\$ -
TOTAL:				76,200.00
JUSTIFICATION/COMMENTS:				

BUDGET JUSTIFICATION - EQUIPMENT AND MOTOR VEHICLES

Period: July 1, 2018 to June 30, 2019

Applicant: Maui Arts & Cultural Center

DESCRIPTION EQUIPMENT	NO. OF ITEMS	COST PER ITEM	TOTAL COST	TOTAL BUDGETED
N/A			\$ -	
			\$ -	
			\$ -	
			\$ -	
			\$ -	
TOTAL:				
JUSTIFICATION/COMMENTS:				

DESCRIPTION OF MOTOR VEHICLE	NO. OF VEHICLES	COST PER VEHICLE	TOTAL COST	TOTAL BUDGETED
N/A			\$ -	
			\$ -	
			\$ -	
			\$ -	
			\$ -	
TOTAL:				
JUSTIFICATION/COMMENTS:				

BUDGET JUSTIFICATION - CAPITAL PROJECT DETAILS

Period: July 1, 2018 to June 30, 2019

Applicant: Maui Arts & Cultural Center

FUNDING AMOUNT REQUESTED						
TOTAL PROJECT COST	ALL SOURCES OF FUNDS RECEIVED IN PRIOR YEARS		STATE FUNDS REQUESTED	OF FUNDS REQUESTED	FUNDING REQUIRED IN SUCCEEDING YEARS	
	FY: 2016-2017	FY: 2017-2018	FY:2018-2019	FY:2018-2019	FY:2019-2020	FY:2020-2021
PLANS			\$ 806,400			
LAND ACQUISITION						
DESIGN / Staffing			\$ 76,200			
CONSTRUCTION	\$ 1,220,000	\$ 1,000,000	\$ 3,617,400			
EQUIPMENT						
TOTAL:	\$ 1,220,000	\$ 1,000,000	\$ 4,500,000			
JUSTIFICATION/COMMENTS: Total project cost of \$6,720,000 of which \$2,220,000 has been secured. The remaining \$4,500,000 is requested for FY18-19						

GOVERNMENT CONTRACTS, GRANTS, AND / OR GRANTS IN AID

Applicant: Maui Arts & Cultural Center

Contracts Total: \$ 1,870,000

	CONTRACT DESCRIPTION	EFFECTIVE DATES	AGENCY	GOVERNMENT ENTITY (U.S. / State / Haw / Hon / Kau / Mau)	CONTRACT VALUE
1	Grant in Aid	07/2017 - 06/2018	OCS	State	\$ 1,000,000
2	Capital Improvements	07/2015 -	OED	Maui	\$ 870,000
3					
4					
6					
7					
10					
11					
12					
13					
14					
15					
16					
17					
18					
19					
20					
21					
22					

MACC Organizational Chart

7/14/15 mp

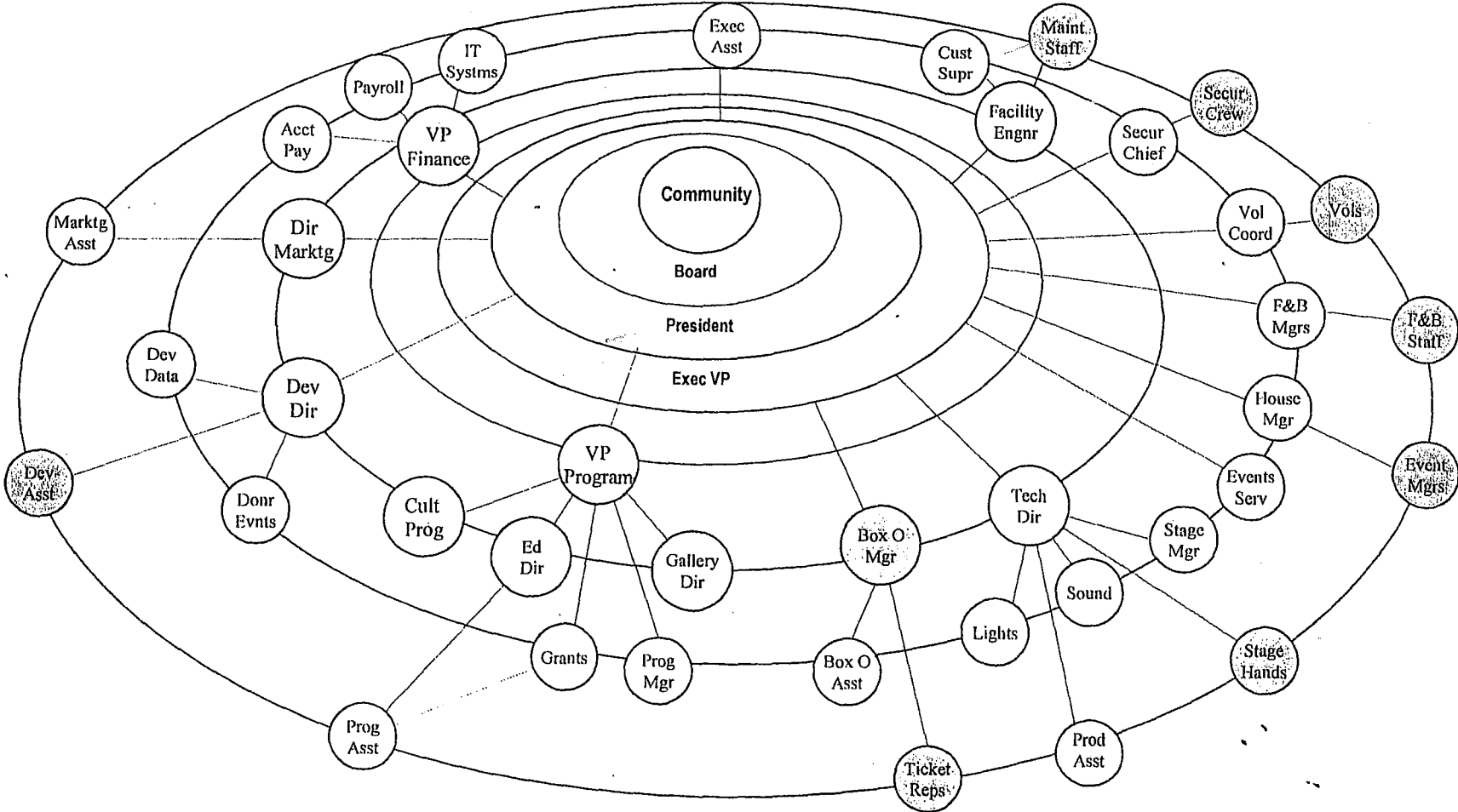



STATE OF HAWAII
STATE PROCUREMENT OFFICE

CERTIFICATE OF VENDOR COMPLIANCE

This document presents the compliance status of the vendor identified below on the issue date with respect to certificates required from the Hawaii Department of Taxation (DOTAX), the Internal Revenue Service, the Hawaii Department of Labor and Industrial Relations (DLIR), and the Hawaii Department of Commerce and Consumer Affairs

Vendor Name: MAUI ARTS & CULTURAL CENTER

DBA/Trade Name: MAUI ARTS & CULTURAL CENTER

Issue Date: 12/13/2017

Status: Compliant

Hawaii Tax#:
New Hawaii Tax#:
FEIN/SSN#:
UI#:
DCCA FILE#:

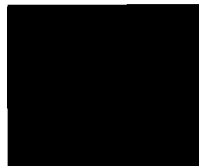

51971

Status of Compliance for this Vendor on issue date:

Form	Department(s)	Status
A-6	Hawaii Department of Taxation	Compliant
	Internal Revenue Service	Compliant
COGS	Hawaii Department of Commerce & Consumer Affairs	Compliant
LIR27	Hawaii Department of Labor & Industrial Relations	Compliant

Status Legend:

Status	Description
Exempt	The entity is exempt from this requirement
Compliant	The entity is compliant with this requirement or the entity is in agreement with agency and actively working towards compliance
Pending	The entity is compliant with DLIR requirement
Submitted	The entity has applied for the certificate but it is awaiting approval
Not Compliant	The entity is not in compliance with the requirement and should contact the issuing agency for more information

Maui 
Arts & Cultural Center

2018-19 GIA REQUEST

MAUI ARTS & CULTURAL CENTER 2018-19 GIA REQUEST

PROJECT COMPONENTS

- 1 Connection to Existing Parking Lot in Keopuolani Park (Funded)
- 2 Maintenance & Equipment Storage Building (Funded)
- 3 Additional Dance Studios/Classrooms (GIA Priority #1)
- 4 Community Stage & Stage Cover (GIA Priority #2)
- 5 Community Events Lawn Support Infrastructure (GIA Priority #3)
- 6 Community Stage Support Spaces & Outfitting (GIA Priority #4)

ADDITIONAL MASTER PLAN COMPONENTS

- 7 Expand Photovoltaic Array
- 8 Makai Plaza
- 9 Relocated Service Roadway
- 10 Reserved Parking
- 11 Cultural Amphitheater
- 12 Coastal Garden
- 13 Expand Main Parking Lot
- 14 Electronic Digital Venue Signage

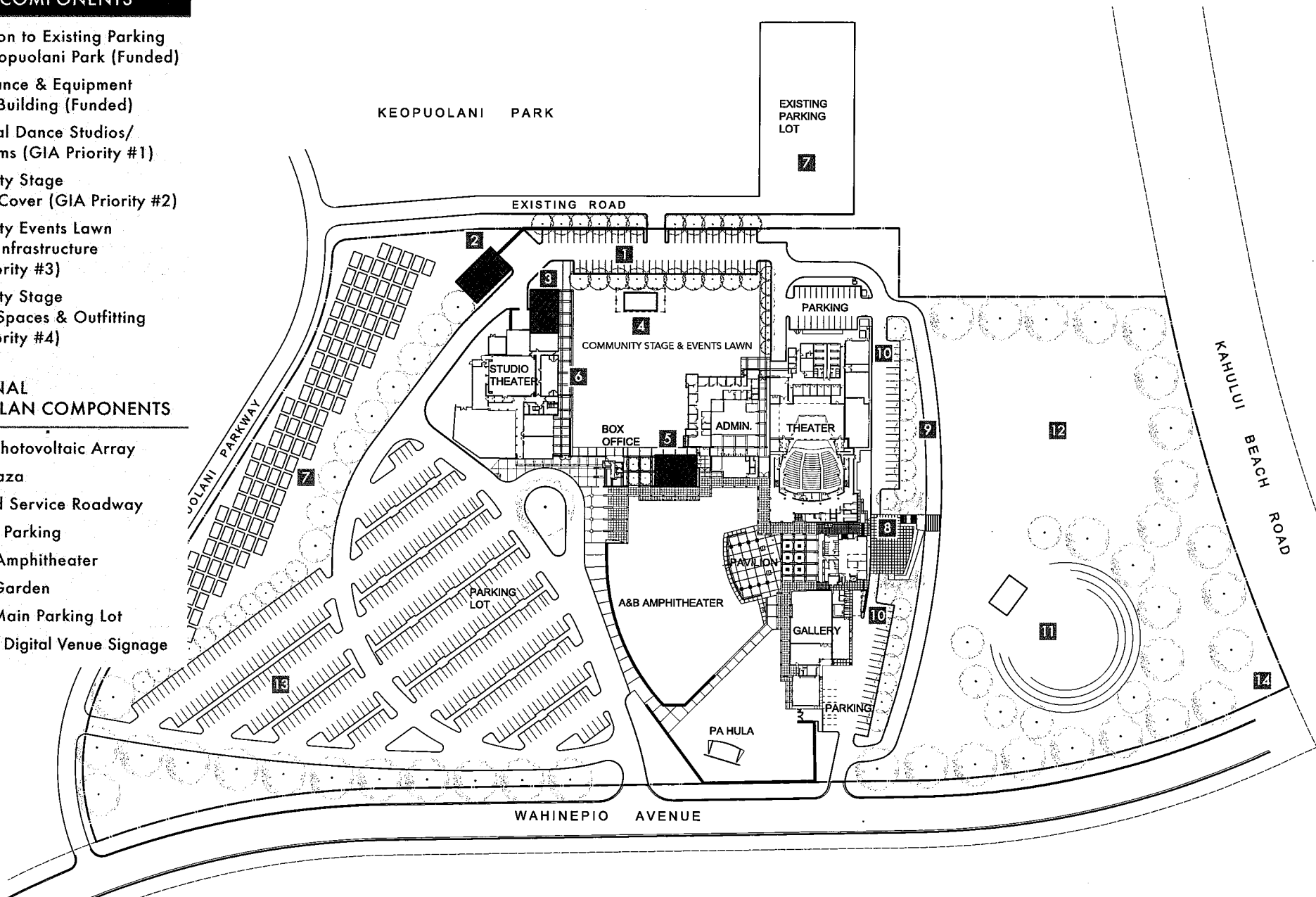

1 CONNECTION TO EXISTING PARKING LOT IN KEOPUOLANI PARK (FUNDED)

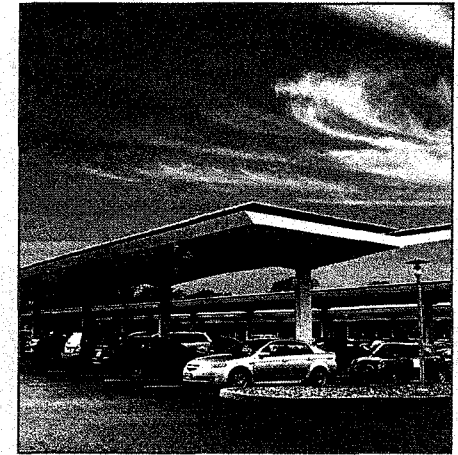
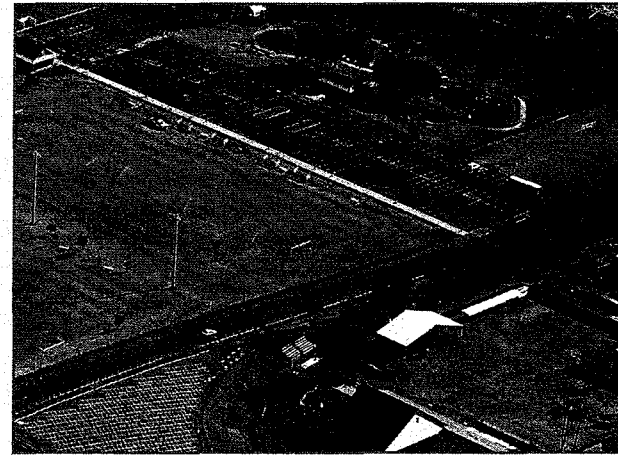
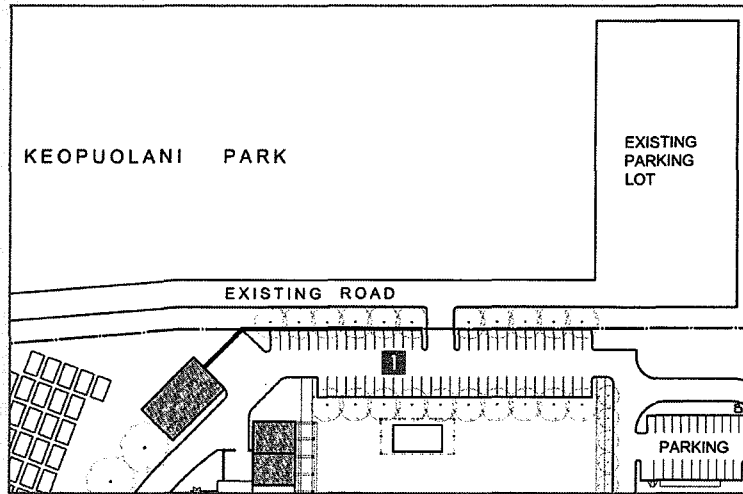

OBJECTIVE

- Create a seamless connection to the existing 250 parking stalls directly behind the MACC in Keopuolani Park.
- Create 59 additional spaces in the linking process that can be used for overflow parking for large casts using backstage as well as those using the additional studios/classrooms and Events Lawn.
- Create a means of egress from the MACC site in the Wailuku direction separate from the existing Kahului side entrances. This additional egress location allows for the service road modification.

NEED

On-site parking is often at a premium for large events as well as Castle Theater events with large casts and crew. There exist 250 parking stalls adjacent to the rear of Castle Theater in Keopuolani Park. If appropriately linked to the MACC, these stalls could provide overflow parking needs for a variety of events. The existing stalls in the park are used primarily during the day for sports related activities. At night, the parking area is rarely used, and when so used, seldom at capacity.

DETAILS

- Create a link from the rear of the MACC to the existing stalls in the park.
- Make the new service road that links to the existing parking wide enough to allow for the creation of 59 additional spaces along a double loaded parking lot design.
- Document and confirm with the County of Maui an agreement for concurrent use for the 250 stalls.
- Install gated vehicular access to and from the existing 250 stalls controlled by the MACC.
- Build gated and lighted pedestrian walkway and wheelchair access to and from the existing 250 stalls controlled by the MACC.
- Landscape area consistent with existing parking lots and hillside.

ADDITIONAL OPPORTUNITIES

The additional parking stalls created are in a good orientation to allow for covered parking using photovoltaic panels. The covered parking can be added as part of a power purchase agreement if funds are limited. Adding photovoltaic panels above parking stalls is much easier and therefore cost effective if done at the time of installing the original parking and asphalt rather than retrofitting/cutting existing lots.

2 MAINTENANCE & EQUIPMENT STORAGE BUILDING (FUNDED)

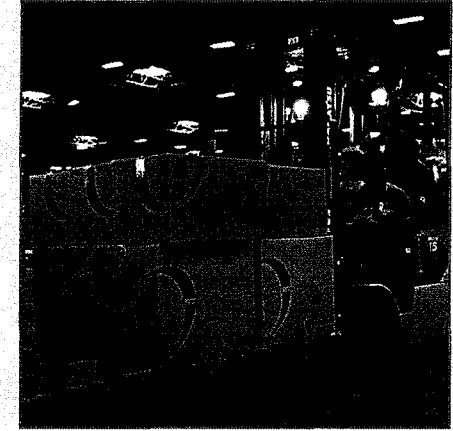
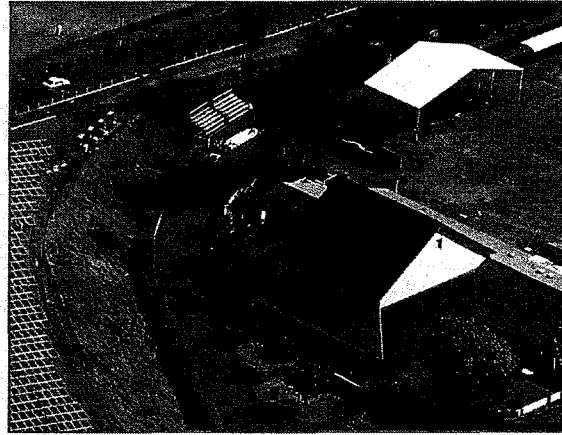
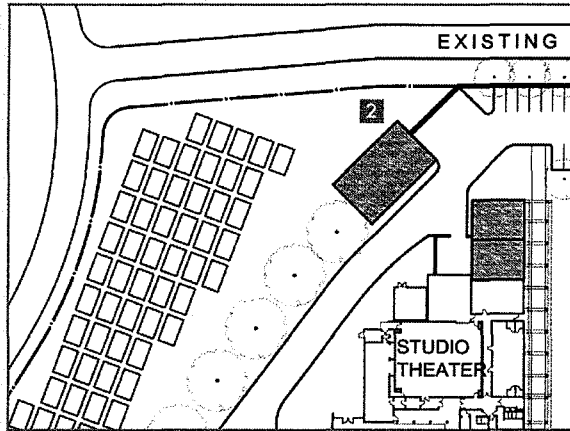

OBJECTIVE

- House all maintenance staff, equipment and supplies efficiently in a single location.
- Locate building in an area that is part of the complex, accessible for moving equipment around, but not use prime real estate for support buildings.
- Create indoor storage to prolong life cycle of equipment.
- Create adequate storage for growth to enable purchasing of equipment and event production inventory.
- Eliminate (a) haphazard temporary storage containers on site (b) marked-up costs of rental equipment.

NEED

Current maintenance staff and equipment are located in multiple areas taking up valuable real estate within the main complex and adding redundancy to both inventory and footprint. Many of the areas are not designed as maintenance but have been used as interim solutions. Existing/Ad hoc maintenance and storage areas within the current building footprint can be freed up for higher and more efficient uses. Current overflow storage into shipping containers can be eliminated.

DETAILS

- Build Maintenance and Storage facility between the rear of the McCoy Studio Theater and the existing adjacent park road.
- Locate the storage building to be out of view from main entrance and parking lot and incorporate design elements to mitigate its visibility.
- Provide adequate building footprint for all equipment required for events such as portable staging equipment, large inventory of tables and chairs, signage, crowd controls supplies etc.
- House daily maintenance equipment including golf carts, forklifts, landscape equipment, and fire rated paint storage etc. in the new building
- Harmonize design with adjacent and current photovoltaic installation and future adjacent parking lot connection.
- Landscape area consistent with existing parking lot and hillside.

ADDITIONAL OPPORTUNITIES

Maintenance Building can be designed to be integrated into the existing hillside. Since this is one of the few buildings on site that does not require peak nighttime energy demands and has limited public access it can be a prime candidate for integrated LEED energy and building concepts. LEED will require additional up front funding, but will reduce long-term costs.

3 ADDITIONAL DANCE STUDIOS/CLASSROOMS (GIA FUNDING PRIORITY #1)

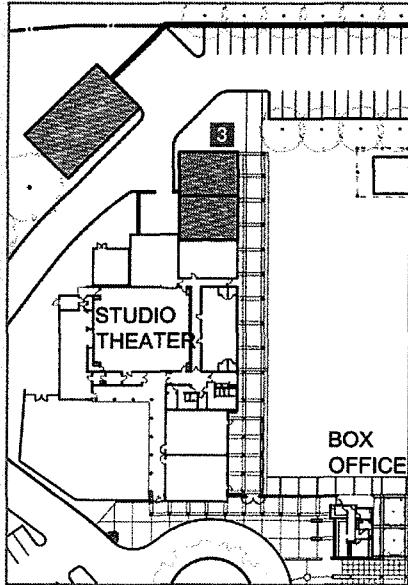

OBJECTIVE

- Add two additional studios/classroom spaces to the existing two Omori Studios.
- Create additional studios/classroom spaces to allow for:
 - The continuation and expansion of the MACC's nationally recognized Arts Education/Can Do Days.
 - Additional space available to expand current classes that are at full capacity in hula, ballet, jazz, tap, hip hop and ballroom dance.

NEED

MACC's Arts Education program has been lauded as a model for integrating arts education and learning into the classroom. The program has maximized the use of currently available space including the use of temporary adhoc space. The ability to expand this successful program is limited by available space. The expanded classrooms will allow the program to operate in more efficient instruction spaces, as well as to expand current opportunities for the children of Maui.

Current classes held in the existing space are at maximum capacity. Disciplines include jazz, tap, ballet, hip hop and ballroom dancing.

Three hula halau use the studios as the core location for their halau instruction. The additional space will enhance scheduling of the halau's instruction time.

DETAILS

- Build two flexible studio spaces on the Wailuku side of the McCoy Studio Theater
- Extend current arcade to connect pedestrian access with the existing studios and arcade and provide design integrity.
- Provide access to expanded rear parking area via the extended arcade.
- Equip studios with sprung wooden floors.
- Build studios with high ceilings to accommodate ballet lifts and jumps
- Landscape area consistent with surroundings.

ADDITIONAL OPPORTUNITIES

The added studios can also be used as support spaces for the activities that occur on the Community Stage & Events Lawn.

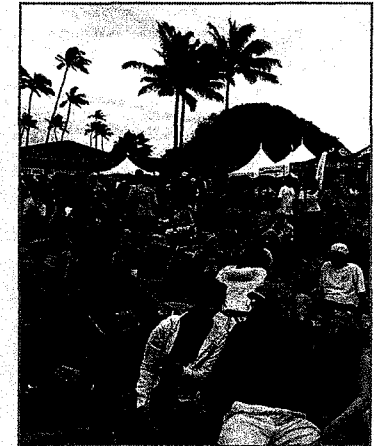
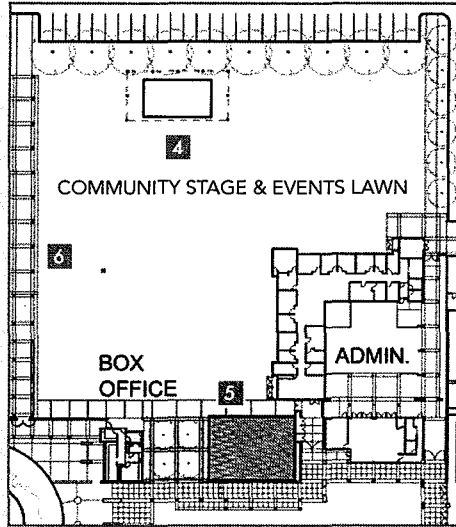

OBJECTIVE

- Complete the Community Stage & Events Lawn to provide a turnkey event space for community festival type events.
- Create restroom and support facilities to service both Community Events Lawn and the A&B Amphitheater.
- Complete the landscaping to complement the functional use of the space and provide windbreaks, as needed.
- Build the Community Stage & Events Lawn to allow for flexibility in scheduling outdoors events. Should an event need to be outside on a very particular date, while a Castle Theater event is already booked, the event can proceed in the community venue and not compromise the traffic flow in and out of the Castle Theater.

NEED

An accessible and complementary outdoor community events space is a current gap in MACC's inventory. Completing the shell that is the current Events Lawn would provide an opportunity to host a variety of festivals that currently are making do in haphazard spaces around the island. Festivals celebrating our island culture, such as the Tahitian Festival, Barrio Festival, etc. could call the Community Stage & Events Lawn home. The addition of built-in bathrooms would eliminate the rental expense for portable toilets and create a sense of permanence and comfort for the public using the spaces.

A space that is complementary to the A&B Amphitheater is often needed for events that are not in the market for the full resources of the A&B Amphitheater. MACC's ability to support the community programming envisioned by the build-out is consistent with the Center's mission.

DETAILS

- Complete the outfitting of the space to include but not limited to: power distribution, staging, area lighting, restrooms and landscaping.
- Create entrances for the restrooms from both the Events Lawn direction and the Amphitheater side allowing for maximum accessibility and use, depending upon which areas are in use at any given time.
- Create a gated pedestrian entrance to the Community Stage & Events Lawn from the A& B Amphitheater via a small plaza that transitions from one venue to the other venue.
- Landscape area consistent with existing parking lots and hillside.
- Provide convenient access to parking area.

ADDITIONAL OPPORTUNITIES

The outfitting of the Community Stage & Events Lawn creates additional opportunities in the future to host nationally touring festivals that require multiple stages to be set up for staggered use throughout the day. Other festival concepts made possible by outfitting the Events Lawn include food or beverage themed events that require the support areas for food, be separate from the reserved seating area for the musical portion of the event.