

House District(s) 16____
Senate District(s) 8____

THE TWENTY-NINTH LEGISLATURE
APPLICATION FOR GRANTS
CHAPTER 42F, HAWAII REVISED STATUTES

Log No:

For Legislature's Use Only

Type of Grant Request:

GRANT REQUEST - OPERATING

GRANT REQUEST - CAPITAL

"Grant" means an award of state funds by the legislature, by an appropriation to a specified recipient, to support the activities of the recipient and permit the community to benefit from those activities.

"Recipient" means any organization or person receiving a grant.

STATE DEPARTMENT OR AGENCY RELATED TO THIS REQUEST (LEAVE BLANK IF UNKNOWN): DEPT OF AGRICULTURE OR AGRICULTURAL DEVELOPMENT CORP.,
STATE PROGRAM I.D. NO. (LEAVE BLANK IF UNKNOWN): _____

1. APPLICANT INFORMATION:

Legal Name of Requesting Organization or Individual:
Kumano I Ke Ala o Makaweli

Dbas: Kumano I Ke Ala

Street Address:

N/A

Mailing Address:

PO Box 181 Waimea, HI. 96796

2. CONTACT PERSON FOR MATTERS INVOLVING THIS APPLICATION:

Name KAINA MAKUA

Title Program Director

Phone # 808-346-9463

Fax # _____

E-mail kumanoikeala@gmail.com

3. TYPE OF BUSINESS ENTITY:

- NON PROFIT CORPORATION INCORPORATED IN HAWAII
- FOR PROFIT CORPORATION INCORPORATED IN HAWAII
- LIMITED LIABILITY COMPANY
- SOLE PROPRIETORSHIP/INDIVIDUAL
- OTHER

6. DESCRIPTIVE TITLE OF APPLICANT'S REQUEST:

FUNDING REQUEST FOR MATCHING FUNDS TO DEVELOP A CONCEPTUAL PLAN TO BUILD OUT 20 ACRES OF FARMLAND ON WEST KAUAI AND CREATE ORGANIZATIONAL INFRASTRUCTURE TO SUPPORT FARM AND AINA-BASED EDUCATION PROGRAMMING.

4. FEDERAL TAX ID #: _____

5. STATE TAX ID #: _____

7. AMOUNT OF STATE FUNDS REQUESTED:

FISCAL YEAR 2019: \$ 150,000

8. STATUS OF SERVICE DESCRIBED IN THIS REQUEST:

- NEW SERVICE (PRESENTLY DOES NOT EXIST)
- EXISTING SERVICE (PRESENTLY IN OPERATION)

SPECIFY THE AMOUNT BY SOURCES OF FUNDS AVAILABLE AT THE TIME OF THIS REQUEST:

STATE \$ _____

FEDERAL \$ _____

COUNTY \$ _____

PRIVATE/OTHER \$ _____

TYPE OF REPRESENTATIVE

KAINA MAKUA - Program Director

1/19/18

Application for Grants

Please check the box when item/section has been completed. If any item is not applicable to the request, the applicant should enter "not applicable".

I. Background and Summary

This section shall clearly and concisely summarize and highlight the contents of the request in such a way as to provide the State Legislature with a broad understanding of the request. Please include the following:

1. A brief description of the applicant's background;

Kumano I Ke Ala (KIKA) is a non-profit organization located in Waimea, Kauai. KIKA's vision is to empower a sustainable west Kauai and restore its cultural resources. KIKA's mission is to build a foundation of Aloha Aina through Native Hawaiian cultural education to grow self-directed, critical thinkers for a sustainable West Kauai.

KIKA is based in Makaweli Valley on Kauai. Makaweli Valley is located on the west side of the island of Kauai. Once home to a thriving agricultural community where loi kalo (wetland taro patches) flourished. As time has passed, the industry of mahi ai kalo (taro farming) and other traditional forms of Native Hawaiian agriculture has diminished greatly. However, as there is an increasing need for food security throughout Hawaii and communities are clamoring to find ways to implement sustainable means of agriculture, the footprint of what once was in this region, is ripe to be re-established.

KIKA runs a series of programs centered on restoration of natural and cultural resources, traditional and contemporary agriculture, cultural education, youth mentorship, and environmental stewardship. The organization served over 1,000 students and volunteers last year.

2. The goals and objectives related to the request;

As the KIKA organization's reach grows and programs expand, a proper conceptual plan is essential to the various purposes that KIKA serves. Construction of multi-purpose facilities, crop research, land surveying, and organizational design are all necessary to ensure that KIKA is able to achieve its mission. This request is for matching funds to plan and design the build out of 20-acres of agricultural land to be used for crop production and farm education.

KIKA's home base is on 10-acres of loi kalo (taro wetlands) land in Makaweli valley and the organization has recently attained a lease for another 10-acres of mala (dry-land farm) land in nearby Waimea. Both parcels are in the process of invasive species removal. Once the land is cleared of invasive species, the goal is to continue to build out programs that serve this community. Most especially for the youth in the areas of agriculture, sustainability, culture, and leadership and life-skills mentoring.

3. The public purpose and need to be served;

Once the plan is implemented, lands will be in production and education programs will be serving regional and island-wide youth. There are numerous public purposes to be served: 1. Increased food production on

west Kauai; 2. Increased access to fresh, locally grown produce on west Kauai; 3. Youth training and mentorship; 4. Growing a new generation of farmers; 5. Building community capacity to care for resources; 6. Development of community controlled eco-tourism activity 7. Economic growth and workforce development. All of these purposes will contribute to a thriving, sustainable community on west Kauai that will result in a higher quality of life for its residents.

4. Describe the target population to be served; and

Kauai is the oldest of the inhabited Hawaiian Islands, with a population of approximately 69,512. The island has evolved from a primarily agricultural community to one that relies heavily on tourism. In addition, the rest of the workforce supports the arts, entertainment, recreation, accommodation and food services. Education, health and social services make up approximately 18% and 14 % in retail. Of the population of Kauai, 86 % of the adults have a high school diploma and 21 % have a bachelor's degree or graduate degree. The island has only one small community college (Kauai Community College), which is an extension of the University of Hawaii system.

West Kauai, in which the Waimea and Kekaha communities are located, geographically, it is the most Northwestern small town in the U.S.A. Kekaha is the 4th largest community on the island of Kauai and is situated 17 nautical miles from the privately owned island of Niihau that limits residency exclusively to the families of NH's. Kekaha is a rural plantation community that serves civilian and military families from the Barking Sands and Kekaha areas. Unemployment here is higher than the State average, and the per capita income is in the bottom third of the State. The percentage of individuals over age 65 living in poverty is higher than in most other communities. In the State, Kekaha has the third-lowest percentage of adults who have completed high school and less than 14% earned a college degree. Kekaha Elementary is one of eight schools in the Waimea complex, which consists of one high school (Waimea High), one middle school (Waimea Canyon Middle), and 4 elementary schools (Eleele, Kalaheo, Kekaha, and Niihau) and two charter schools (Ke Kula Ni'ihau O Kekaha and KANAKA).¹

It is well established that individuals living in poverty have significant risk factors including emotional and social challenges, acute and chronic stressors, cognitive lags & health and safety issues.²

5. Health Data. Table 1

Based on 2015 County Health Ranking Report	
	Kauai
Teen Birth Rate (per 1000 births)	42
Uninsured	8%
Unemployed	5.7%
Children in Poverty	16%
Children in Single Parent Households	27%

Source: 2015 www.countyhealthrankings.org

¹ Native Hawaiian Research Center & The Center on the Family (2005). Multi-Ethnic Hawaiians are Making Strides in Academic Achievement. Retrieved from <http://www.thelearningcoalition.org/wpcontent/uploads/2012/10/MultiEthnic%20Hawaiians%20Are%20Making%20Strides%20in%20Academic%20Achievement.pdf>

² Jensen, E. (2015). Teaching with poverty in mind. How poverty affects behavior and academic performance. Retrieved from: <http://www.ascd.org/publications/books/109074/chapters/How-Poverty-Affects-Behavior-and-Academic-Performance.aspx>

The programs that Kumano will run once the plan and design is complete and implemented will serve community members of all ages, but especially Native Hawaiian students' ages 8 to 18 (age is not an absolute criteria for inclusion) in grades K-12 and their families; identified as the most socio-economically disadvantaged in Hawaii. The participants to be served will be youth from all regional schools, identified as Title I, located in central and west Kauai: (1) Waimea Canyon Middle School, (2) Waimea High School, (3) Eleele Elementary School, (4) Kawaikini Charter School, (5) Ke Kula Ni'ihau O Kekaha Charter School, and (6) Kula Aupuni Ni'ihau A Kahelelani Aloha Charter School. According to Mel Riddile, of the National Association for Secondary School Principals, "Researchers report that perhaps the only true linear relationship in the social sciences is the relationship between poverty and student performance. While there is no relationship between poverty and ability, the relationship between poverty and achievement is almost foolproof. To deny that poverty is a factor to be overcome as opposed to an excuse is to deny the reality that all educators, human services workers, law enforcement officers, medical professionals and religious clergy know and have known for years."

6. *Participant Schools – General Statistics. Table 2*

Participant School	Student Population	% Free or Reduced Lunch
Waimea Canyon Middle School	385	54.81%
Waimea High School	581	51.7%
Kawaikini Charter School	136	61.76%
Ke Kula Ni'ihau O Kekaha Charter School	44	77.27%
Kula Aupuni Ni'ihau A Kahelelani Aloha Charter School	60	95%

NH = Native Hawaiian Population

Native Hawaiian Students

Native Hawaiians represent the highest percentage of economically disadvantaged youth in Hawaii's public school system. In 2010, 43.9% of all public school students in Hawai'i were eligible for the free and reduced cost lunch program. Among NH students in the public school system, more than half participated in the subsidized school lunch program (52%), which is 14% higher than their non-Hawaiian peers. In predominantly NH schools, the average participation rate in the subsidized school lunch program in 2010 was 13% higher than the State average.³

Native Hawaiian students are found to score the lowest on standardized tests of any ethnic group in the public school system statewide (Native HI Educational Assessment, 2005; Kaniaiapuni and Ishibashi, 2003). School absenteeism is the highest among NH public school students, which is a contributing factor to the high NH dropout rate and low academic performance levels. Obstacles within the school as well as problems at home can negatively impact NH student interest in pursuing future training or education. A substantial number of students are not prepared to find employment or pursue additional education after high school (Will, 1986, Lipsky and Gartner, 1992, Cooke, 2001, SEDL, 1995).

³ Native Hawaiian Research Center & The Center on the Family (2005). Multi-Ethnic Hawaiians are Making Strides in Academic Achievement. Retrieved from <http://www.thelearningcoalition.org/wpcontent/uploads/2012/10/MultiEthnic%20Hawaiians%20Are%20Making%20Strides%20in%20Academic%20Achievement.pdf>

West Kauai Schools

Kawaikini Public Charter School (PCS) is a kindergarten through grade twelve Hawaiian-medium, Hawaiian-culture charter school located in Puhi on the island of Kauai. Established in October 2007, Kawaikini serves students from east and west Kauai; minority enrollment is 95% and economically disadvantage is identified as 77%.

Waimea High School (WHS) is a comprehensive four-year high school, located on the western side of the island of Kauai. Founded in 1882, the school originally opened its doors as an elementary school. In 1935, the school expanded to include grades K-12. Then in 1977, the school assumed its present grade 9-12 structure. The school serves communities from Kalaheo (12-15 miles east of WHS) to the Pacific Missile Range Facility (PMRF) in Mana (approximately 8 miles west of WHS). Feeder schools primarily include Kekaha, Eleele, and Kalaheo Elementary Schools, Waimea Canyon Middle School and to a small extent Chiefess Kamakahalei Middle School. This "blending" of diverse groups includes students from a range of socio-economic backgrounds. In addition, the school serves students whose families of origin reside on the island of Niihau, but who stay with relatives on Kauai. Although West Kauai seems rich in land, economically, the area has not fully recovered from the closing of the last sugar plantation in 2009. Still, despite the unemployment and economic burdens that impact families, residents maintain the caring and close-knit feeling of a rural community.

5. Describe the geographic coverage.

See map of areas attached in **Appendix 1**. The land clearing, restoration, and agriculture production will take place on the highlighted areas. The "Makaweli" parcel sits along the Makaweli River approximately one mile into the valley from the river mouth in Waimea and covers ten acres. The "Makai" parcel is at the entrance of the the Makaweli and Waimea Valleys, situated closer to Waimea town, it is also 10 acres in size. Both sites will be used to host agriculture, culture, and aina-based education programs to community members and youth from the west Kauai region as well as other parts of the island.

II. Service Summary and Outcomes

The Service Summary shall include a detailed discussion of the applicant's approach to the request. The applicant shall clearly and concisely specify the results, outcomes, and measures of effectiveness from this request. The applicant shall:

1. Describe the scope of work, tasks and responsibilities;

The scope of work for this conceptual plan request will be to draft a conceptual plan for use of the 20 acres of agricultural lands, to include crop feasibility, water and soil studies, construction plan/timeline for facilities, and an organizational structure to ensure the mission is fulfilled. Professional consultants will be contracted to manage the planning project and a professional planning firm will be hired to carry out the research and planning to create finished plan.

2. Provide a projected annual timeline for accomplishing the results or outcomes of the service; This planning project will take 12 months to complete. Data collection and research will take nine months and another 3 months to assemble the plan.

September 2018 – May 2019: Research and data collection (surveys, water and soil sampling, entitlement research, crop feasibility research, organizational planning and consulting, community outreach and input gathering)

June 2019 – August 2019: Data compilation and plan development.

September 2019: Final plan completed.

3. Describe its quality assurance and evaluation plans for the request. Specify how the applicant plans to monitor, evaluate, and improve their results; and

There will be a competitive application solicited for project manager and planning services from professionals in the area of strategic and master planning. The applications will be reviewed by KIKA board members and staff to determine the most qualified applicants. Once a contractor(s) is selected and the work commences, KIKA staff will meet with the contractors regularly to assist in the research in the data collection necessary to complete the plans. Monthly progress reports/updates to KIKA board and staff will be required of the contractor.

4. List the measure(s) of effectiveness that will be reported to the State agency through which grant funds are appropriated (the expending agency). The measure(s) will provide a standard and objective way for the State to assess the program's achievement or accomplishment. Please note that if the level of appropriation differs from the amount included in this application that the measure(s) of effectiveness will need to be updated and transmitted to the expending agency.

KIKA will make all monthly updates and reports previously described available to the expending agency to ensure transparency and completion of the project in a timely fashion. KIKA will also make available any reports that indicate necessary changes to workplan, budget, or timeline that may be needed to accommodate unexpected events.

III. Financial

Budget

1. The applicant shall submit a budget utilizing the enclosed budget forms as applicable, to detail the cost of the request.
- a. Budget request by source of funds ([Link](#))
 - b. Personnel salaries and wages ([Link](#))
 - c. Equipment and motor vehicles ([Link](#))
 - d. Capital project details ([Link](#))
 - e. Government contracts, grants, and grants in aid ([Link](#))
2. The applicant shall provide its anticipated quarterly funding requests for the fiscal year 2019.

Quarter 1	Quarter 2	Quarter 3	Quarter 4	Total Grant
75,000		75,000		150,000

3. The applicant shall provide a listing of all other sources of funding that they are seeking for fiscal year 2019.

Other funding sources for this project will come from the following sources:

Private Funding: \$52,400 (Secured)
County of Kauai: \$10,000 (Pending)

4. The applicant shall provide a listing of all state and federal tax credits it has been granted within the prior three years. Additionally, the applicant shall provide a listing of all state and federal tax credits they have applied for or anticipate applying for pertaining to any capital project, if applicable.
Not applicable – no tax credits have been granted to KIKA in last 3 years.

5. The applicant shall provide a listing of all federal, state, and county government contracts, grants, and grants in aid it has been granted within the prior three years and will be receiving for fiscal year 2019 for program funding.

FY2016:

Kukulu Ola and Community Restoration - HTA - \$40,000

FY2017:

Grant-in-Aid – Hawaii State Legislature - \$95,000

Kukulu Ola and Aloha Aina Restoration – HTA - \$82,000

FY 2018:

Aloha Aina Restoration - \$30,000 (Yet to be dispersed)

Agriculture, Tourism, Education - County of Kauai - \$53,850 (Yet to be Dispersed)

6. The applicant shall provide the balance of its unrestricted current assets as of December 31, 2017.

Zero

IV. Experience and Capability

1. Necessary Skills and Experience

The applicant shall demonstrate that it has the necessary skills, abilities, knowledge of, and experience relating to the request. State your experience and appropriateness for providing the service proposed in this application. The applicant shall also provide a listing of verifiable experience of related projects or contracts for the most recent three years that are pertinent to the request.

KIKA is an agriculture and aina-based education organization. Between three staff members, there are 40 plus years of farming experience on west Kauai and 2 certified teachers, that combined, have 20 years of teaching experience. The organization is serving 1,000 plus volunteers annually, and has already cleared nearly 10 acres of invasive species in an effort to restore agricultural lands.

There is a wealth of knowledge, expertise and will within KIKA to ensure that any plans developed will be carried out to their fullest extent and that the west Kauai community is served.

In the areas of restoration, agriculture, education, and community development, KIKA has partnered with numerous organizations to carry out work that has delivered significant results and outcomes. Some of

those partners that can verify the work product and capacity of KIKA are, County of Kauai, Kamehameha Schools, Waimea High School, Waimea Canyon Middle School, R.E.A.C.H. Hawaii, Department of Vocational Rehabilitation, Alu Like, Office of Hawaiian Affairs, and Kilohana Canoe Club to name a few.

2. **Facilities**

The applicant shall provide a description of its facilities and demonstrate its adequacy in relation to the request. If facilities are not presently available, describe plans to secure facilities.

Currently, KIKA is based on a loi complex in Makaweli Valley, with only traditional structure (thatched haled) and outhouses as facilities. This is where educational program and farming takes place. It has a community partner that allows for usage of office space in a building in Waimea, approximately 2 miles from the loi. The current request is for plans that will provide a path to building a permanent multi-purpose facility eventually.

V. Personnel: Project Organization and Staffing

1. **Proposed Staffing, Staff Qualifications, Supervision and Training**

The applicant shall describe the proposed staffing pattern and proposed service capacity appropriate for the viability of the request. The applicant shall provide the qualifications and experience of personnel for the request and shall describe its ability to supervise, train and provide administrative direction relative to the request.

KIKA staff and Board of Directors has oversight over all KIKA affairs including contracts related to this request.

KIKA Staff includes Kaina Makua (Masters Degree in Education, Certified Teacher, Kalo Farmer); Berna Souza (Certified Teacher, Non-Profit Administrator), these two individuals will work with contractor(s) to ensure completion of the conceptual plan project and implementation with oversight from the Board of Directors.

2. **Organization Chart**

The applicant shall illustrate the position of each staff and line of responsibility/supervision. If the request is part of a large, multi-purpose organization, include an organization chart that illustrates the placement of this request.

See Appendix 2 attached.

3. **Compensation**

The applicant shall provide the annual salaries paid by the applicant to the three highest paid officers, directors, or employees of the organization by position.

The KIKA Board is comprised of volunteers.

Highest Paid Employees:

VI. Other

1. **Litigation**

The applicant shall disclose any pending litigation to which they are a party, including the disclosure of any outstanding judgement. If applicable, please explain.

Not applicable - no litigation or outstanding judgments

2. **Licensure or Accreditation**

The applicant shall specify any special qualifications, including but not limited to licensure or accreditation that the applicant possesses relevant to this request.

Not applicable

3. **Private Educational Institutions**

The applicant shall specify whether the grant will be used to support or benefit a sectarian or non-sectarian private educational institution. Please see Article X, Section 1, of the State Constitution for the relevance of this question.

Not applicable

4. **Future Sustainability Plan**

The applicant shall provide a plan for sustaining after fiscal year 2018-19 the activity funded by the grant if the grant of this application is:

(a) Received by the applicant for fiscal year 2018-19, but

(b) Not received by the applicant thereafter.

The funding requested is to provide matching funds to develop a conceptual plan for use of 20 acres of agricultural land and organizational strategies to achieve the organization's mission. After fiscal year 2018-19, KIKA will be producing crops for sale that will help fund core positions perennially. Development of partnerships with organizations that also provide resources, such as Kamehameha Schools and Alu Like are also ongoing.

5. **Certificate of Good Standing (If the Applicant is an Organization)**

If the applicant is an organization, the applicant shall submit one (1) copy of a certificate of good standing from the Director of Commerce and Consumer Affairs that is dated no earlier than December 1, 2017.

Attached

6. Declaration Statement

The applicant shall submit a declaration statement affirming its compliance with Section 42F-103, Hawaii Revised Statutes. ([Link](#))

7. Public Purpose

The applicant shall specify whether the grant will be used for a public purpose pursuant to Section 42F-102, Hawaii Revised Statutes. ([Link](#))

The funds requested will be used for a public purpose, to serve west Kauai youth, increase food production, and economic development for west Kauai.



Department of Commerce and Consumer Affairs

CERTIFICATE OF GOOD STANDING

I, the undersigned Director of Commerce and Consumer Affairs of the State of Hawaii, do hereby certify that

KUMANO I KE ALA O MAKAWELI

was incorporated under the laws of Hawaii on 05/20/2015 ; that it is an existing nonprofit corporation; and that, as far as the records of this Department reveal, has complied with all of the provisions of the Hawaii Nonprofit Corporations Act, regulating domestic nonprofit corporations.



IN WITNESS WHEREOF, I have hereunto set my hand and affixed the seal of the Department of Commerce and Consumer Affairs, at Honolulu, Hawaii.

Dated: January 18, 2018

Director of Commerce and Consumer Affairs

**DECLARATION STATEMENT OF
APPLICANTS FOR GRANTS PURSUANT TO
CHAPTER 42F, HAWAII REVISED STATUTES**

The undersigned authorized representative of the applicant certifies the following:

- 1) The applicant meets and will comply with all of the following standards for the award of grants pursuant to Section 42F-103, Hawaii Revised Statutes:
 - a) Is licensed or accredited, in accordance with federal, state, or county statutes, rules, or ordinances, to conduct the activities or provide the services for which a grant is awarded;
 - b) Complies with all applicable federal and state laws prohibiting discrimination against any person on the basis of race, color, national origin, religion, creed, sex, age, sexual orientation, or disability;
 - c) Agrees not to use state funds for entertainment or lobbying activities; and
 - d) Allows the state agency to which funds for the grant were appropriated for expenditure, legislative committees and their staff, and the auditor full access to their records, reports, files, and other related documents and information for purposes of monitoring, measuring the effectiveness, and ensuring the proper expenditure of the grant.
- 2) If the applicant is an organization, the applicant meets the following requirements pursuant to Section 42F-103, Hawaii Revised Statutes:
 - a) Is incorporated under the laws of the State; and
 - b) Has bylaws or policies that describe the manner in which the activities or services for which a grant is awarded shall be conducted or provided.
- 3) If the applicant is a non-profit organization, it meets the following requirements pursuant to Section 42F-103, Hawaii Revised Statutes:
 - a) Is determined and designated to be a non-profit organization by the Internal Revenue Service; and
 - b) Has a governing board whose members have no material conflict of interest and serve without compensation.

Pursuant to Section 42F-103, Hawaii Revised Statutes, for grants used for the acquisition of land, when the organization discontinues the activities or services on the land acquired for which the grant was awarded and disposes of the land in fee simple or by lease, the organization shall negotiate with the expending agency for a lump sum or installment repayment to the State of the amount of the grant used for the acquisition of the land.

Further, the undersigned authorized representative certifies that this statement is true and correct to the best of the applicant's knowledge.

Kumano I Ke Ala
(Typed Name of Individual or Organization)



1/19/18
(Date)

Kaina Makua _____ Program Director _____
(Typed Name) (Title)

BUDGET REQUEST BY SOURCE OF FUNDS

Period: July 1, 2018 to June 30, 2019

Appl

Kumano I Ke Ala o Makaweli

BUDGET CATEGORIES	Total State Funds Requested (a)	Total Federal Funds Requested (b)	Total County Funds Requested (c)	Total Private/Other Funds Requested (d)
A. PERSONNEL COST		0		
1. Salaries	0		0	10,000
2. Payroll Taxes & Assessments	0		0	1,200
3. Fringe Benefits	0		0	1,200
TOTAL PERSONNEL COST	0		0	12,400
B. OTHER CURRENT EXPENSES				
1. Planning Contract	90,000		10,000	20,000
2. Research and Data Collection	30,000			20,000
3. Project Management	30,000			
4.				
5.				
6.				
7.				
8.				
9.				
10.				
11.				
12.				
13.				
14.				
15.				
16.				
17.				
18.				
19.				
20.				
TOTAL OTHER CURRENT EXPENSES	150,000		10,000	40,000
C. EQUIPMENT PURCHASES				
D. MOTOR VEHICLE PURCHASES				
E. CAPITAL				
TOTAL (A+B+C+D+E)	150,000		10,000	52,400
SOURCES OF FUNDING		Budget Prepared By:		
(a) Total State Funds Requested	150,000	Berna Souza		
(b) Total Federal Funds Requested	0	Name (Please type or print) Phone		
(c) Total County Funds Requested	10,000	Signature of Authorized Official Date		
(d) Total Private/Other Funds Requested	52,400	Kaine Makua, Program Director		
TOTAL BUDGET	212,400	Name and Title (Please type or print)		

BUDGET JUSTIFICATION - PERSONNEL SALARIES AND WAGES

Period: July 1, 2018 to June 30, 2019

Applicant: KUMANO IKE ALO MAKAWELI

POSITION TITLE	FULL TIME EQUIVALENT	ANNUAL SALARY A	% OF TIME ALLOCATED TO GRANT REQUEST B	TOTAL STATE FUNDS REQUESTED (A x B)
NO STATE FUNDS ARE BEING REQUESTED FOR PERSONNEL				\$ -
				\$ -
				\$ -
				\$ -
				\$ -
				\$ -
				\$ -
				\$ -
				\$ -
				\$ -
				\$ -
				\$ -
				\$ -
				\$ -
				\$ -
				\$ -
				\$ -
TOTAL:				
JUSTIFICATION/COMMENTS:				

BUDGET JUSTIFICATION - EQUIPMENT AND MOTOR VEHICLES

Period: July 1, 2018 to June 30, 2019

Applicant: KUMANO (KE AIA O MAKAWAI)

DESCRIPTION EQUIPMENT	NO. OF ITEMS	COST PER ITEM	TOTAL COST	TOTAL BUDGETED
No funding has been requested for equipment or motor vehicles			\$ -	
			\$ -	
			\$ -	
			\$ -	
			\$ -	
TOTAL:			\$ -	
JUSTIFICATION/COMMENTS:				

DESCRIPTION OF MOTOR VEHICLE	NO. OF VEHICLES	COST PER VEHICLE	TOTAL COST	TOTAL BUDGETED
			\$ -	
			\$ -	
			\$ -	
			\$ -	
			\$ -	
TOTAL:			\$ -	
JUSTIFICATION/COMMENTS:				

BUDGET JUSTIFICATION - CAPITAL PROJECT DETAILS

Period: July 1, 2018 to June 30, 2019

Applicant: KUMANDIKE AIA O MAKAWELI

FUNDING AMOUNT REQUESTED						
TOTAL PROJECT COST	ALL SOURCES OF FUNDS RECEIVED IN PRIOR YEARS		STATE FUNDS REQUESTED	OTHER SOURCES OF FUNDS REQUESTED	FUNDING REQUIRED IN SUCCEEDING YEARS	
	FY: 2016-2017	FY: 2017-2018	FY:2018-2019	FY:2018-2019	FY:2019-2020	FY:2020-2021
PLANS						
LAND ACQUISITION						
DESIGN						
CONSTRUCTION						
EQUIPMENT						
TOTAL:						
JUSTIFICATION/COMMENTS: <p style="text-align: center;">No funding has been requested for capital projects.</p>						

GOVERNMENT CONTRACTS, GRANTS, AND / OR GRANTS IN AID

App:

Kumano | Ke Ala o Makaweli

Contracts Total: 20,000

	CONTRACT DESCRIPTION	EFFECTIVE DATES	AGENCY	GOVERNMENT ENTITY (U.S. / State / Haw / Hon / Kau / Mau)	CONTRACT VALUE
1	Grant from County of Kauai - Office of Economic Development - Stewardship Agreement Funding	TBD	Kauai Office of Economic Development	Kauai	20,000
2					
3					
4					
5					
6					
7					
8					
9					
10					
11					
12					
13					
14					
15					
16					
17					
18					
19					
20					
21					
22					
23					

APPENDIX 1

- Owner of Parcel
- 1. William B. Anderson
 - 2. Mary Ann O'Brien
 - 3. William B. Anderson
 - 4. William B. Anderson
 - 5. William B. Anderson
 - 6. William B. Anderson
 - 7. William B. Anderson
 - 8. William B. Anderson
 - 9. William B. Anderson
 - 10. William B. Anderson
 - 11. William B. Anderson
 - 12. William B. Anderson
 - 13. William B. Anderson
 - 14. William B. Anderson
 - 15. William B. Anderson
 - 16. William B. Anderson
 - 17. William B. Anderson
 - 18. William B. Anderson
 - 19. William B. Anderson
 - 20. William B. Anderson
 - 21. William B. Anderson
 - 22. William B. Anderson
 - 23. William B. Anderson
 - 24. William B. Anderson
 - 25. William B. Anderson
 - 26. William B. Anderson
 - 27. William B. Anderson
 - 28. William B. Anderson
 - 29. William B. Anderson
 - 30. William B. Anderson
 - 31. William B. Anderson
 - 32. William B. Anderson

Plat 01

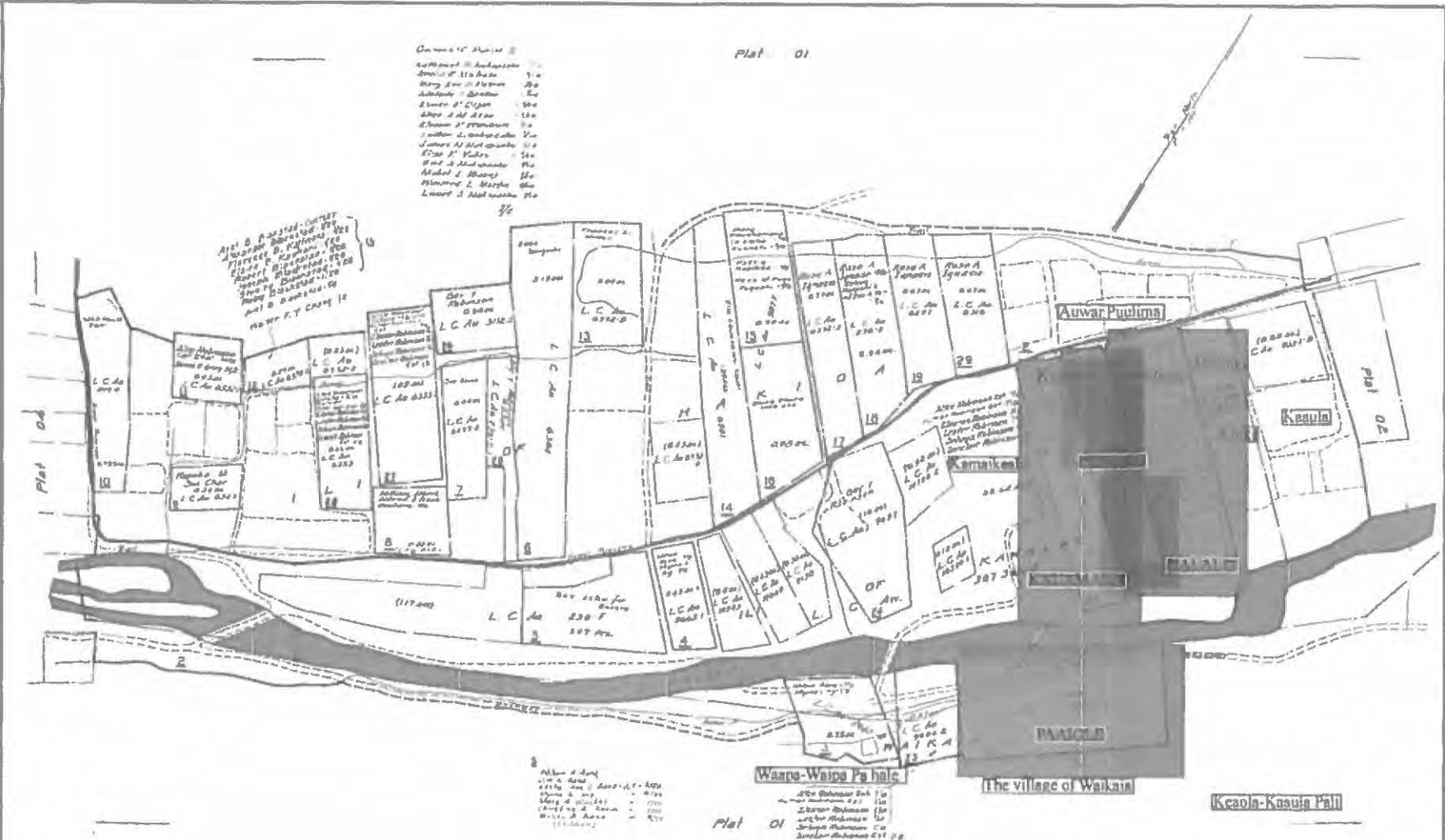

FOR. OF MAKAWALI, WAIMEA KAUA

SUBJECT TO CHANGE

TAXATION MAPS BUREAU			
TERRITORY OF HAWAII			
TAX MAP			
109E	7N	DIVISION	
109E	7N	DIVISION	
1	7	03	
CONTAINING PARCELS			
SCALE 60" = 100'			

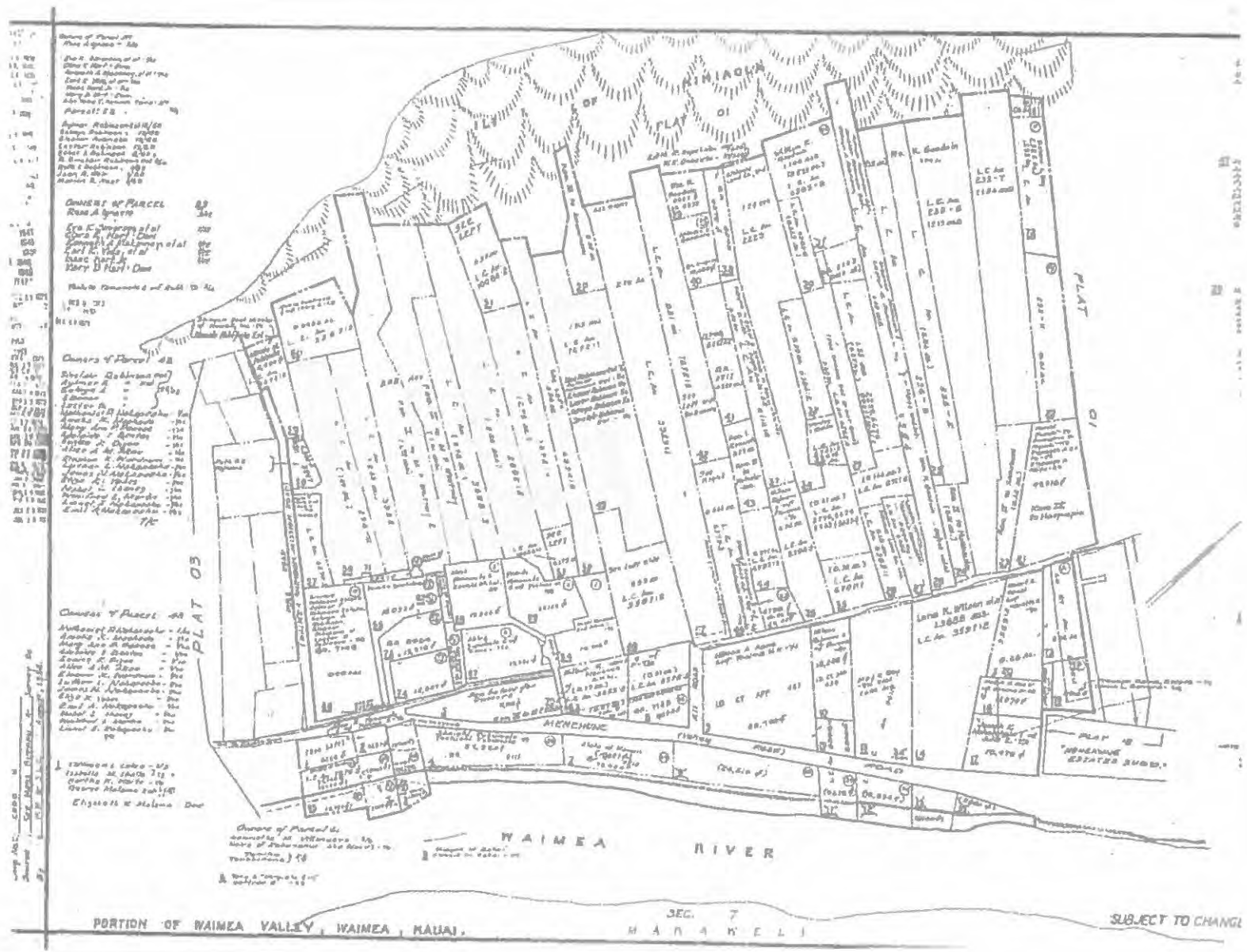

117
 116
 115
 114
 113
 112
 111
 110
 109
 108
 107
 106
 105
 104
 103
 102
 101
 100
 99
 98
 97
 96
 95
 94
 93
 92
 91
 90
 89
 88
 87
 86
 85
 84
 83
 82
 81
 80
 79
 78
 77
 76
 75
 74
 73
 72
 71
 70
 69
 68
 67
 66
 65
 64
 63
 62
 61
 60
 59
 58
 57
 56
 55
 54
 53
 52
 51
 50
 49
 48
 47
 46
 45
 44
 43
 42
 41
 40
 39
 38
 37
 36
 35
 34
 33
 32
 31
 30
 29
 28
 27
 26
 25
 24
 23
 22
 21
 20
 19
 18
 17
 16
 15
 14
 13
 12
 11
 10
 9
 8
 7
 6
 5
 4
 3
 2
 1

Owners of Parcel 100
 (List of names and parcel numbers)
 Owners of Parcel 101
 (List of names and parcel numbers)
 Owners of Parcel 102
 (List of names and parcel numbers)
 Owners of Parcel 103
 (List of names and parcel numbers)
 Owners of Parcel 104
 (List of names and parcel numbers)
 Owners of Parcel 105
 (List of names and parcel numbers)
 Owners of Parcel 106
 (List of names and parcel numbers)
 Owners of Parcel 107
 (List of names and parcel numbers)
 Owners of Parcel 108
 (List of names and parcel numbers)
 Owners of Parcel 109
 (List of names and parcel numbers)
 Owners of Parcel 110
 (List of names and parcel numbers)
 Owners of Parcel 111
 (List of names and parcel numbers)
 Owners of Parcel 112
 (List of names and parcel numbers)
 Owners of Parcel 113
 (List of names and parcel numbers)
 Owners of Parcel 114
 (List of names and parcel numbers)
 Owners of Parcel 115
 (List of names and parcel numbers)
 Owners of Parcel 116
 (List of names and parcel numbers)
 Owners of Parcel 117
 (List of names and parcel numbers)
 Owners of Parcel 118
 (List of names and parcel numbers)
 Owners of Parcel 119
 (List of names and parcel numbers)
 Owners of Parcel 120
 (List of names and parcel numbers)

SUBJECT TO CHANGE

**Kumano I Ke Ala o Makaweli
Organizational Chart**









